

JA90 DOME / TILED

PreAssembled

WHAT IS INCLUDED

Cement/Clay Oven
 Reinforced Cement Base Black Powder Coated or
 Stainless Steel Flue & Cap
 Black Powder Coated or Stainless Steel Arch Cover
 Black Powder Coated or Stainless Steel Slab Cover
 Black Powder Coated Oven Door
 Stainless Steel/Alloy Pizza Paddle
 Rendered or Tiled Finish
 Recipe eBook
 Oven Stand/Stillage (Preassembled only)
 Assembly Instructions (DIY Kit only)
 1 Year Warranty (Conditions Apply)



EXTERNAL DIMENSIONS

Width (left to right)	1255mm
Length (front to back)	1400mm
Dome Height	770mm
Outer Arch Width	650mm
Outer Arch Height	355mm
Flue Base Width	470mm
Front Height	770mm
Front Width	1250mm
Dome Thickness	65mm
Insulation Render Thickness	70-100mm
Rendered Oven Weight	815kg
Tiled Oven Weight	880kg

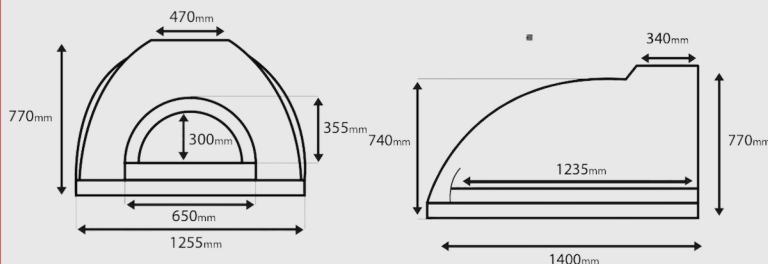

STAND/STILLAGE DIMENSIONS

Width (left to right)	1360mm
Length (front to back)	1600mm
Height (excluding wheels)	975mm
Stand Weight	65kg
Wheel Height	134mm
Wheel Weight	3kg
Rendered Oven Weight and Stand	880kg
Tiled Oven Weight and Stand	945kg



INTERNAL DIMENSIONS

Width (left to right)	930mm
Length (front to back)	1235mm
Dome Height	470mm
Inner Arch Width	600mm
Inner Arch Height	300mm
Floor Brick Thickness	38mm

INTERNAL COOKING AREA

Width (left to right)	930mm
Length (front to back)	850mm

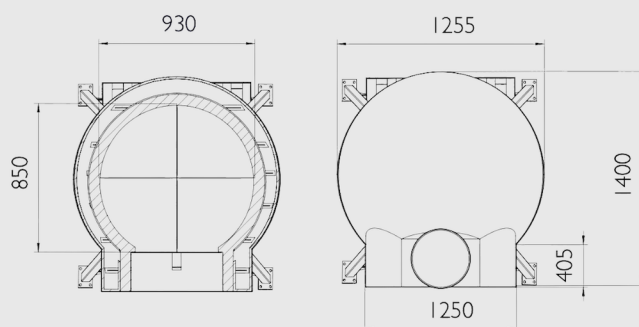

FLUE DIMENSIONS

Flue Height	1000mm
Flue Diameter	150mm
Flue Cap Diameter	275mm

DIY PRECAST KIT

Box Width (left to right)	1140mm
Box Length (front to back)	1180mm
Box Height	960mm
Box Weight - includes kit	400kg
Number of Dome Pieces	4
Weight of Dome Pieces	129kg 97kg 60kg 10kg



Stand / Stillage not included with kits