



# JA60 DOME

## WHAT IS INCLUDED

- Refractory Cement Oven
- Steel Sub Base
- Refractory Brick Floor
- Ceramic Insulation Fibre
- Super Wool Floor Base
- Black Powder Coated Flue & Cap
- Black PVD\* Arch & Slab Cover (JA60 Dome PVD only)
- Black Powder Coated Oven Door
- 1 Year Warranty (Conditions Apply)



All measurements may vary slightly

## EXTERNAL DIMENSIONS

|                               |         |
|-------------------------------|---------|
| Width (left to right)         | 790mm   |
| Length (front to back)        | 860mm   |
| Dome Height                   | 580mm   |
| Outer Arch Width              | 450mm   |
| Outer Arch Height             | 250mm   |
| Flue Base Width               | 320mm   |
| Front Height                  | 480mm   |
| Front Width                   | 680mm   |
| Dome Thickness                | 40mm    |
| Insulation   Render Thickness | 60-90mm |
| Weight                        | 225kg   |

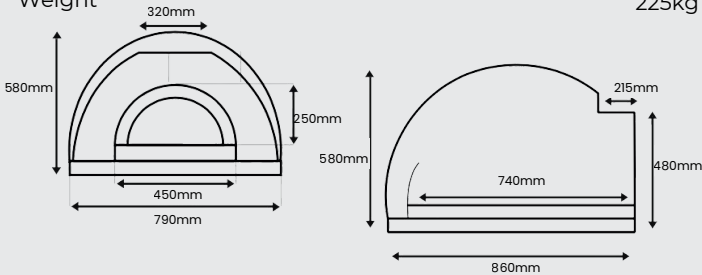

## INTERNAL DIMENSIONS

|                        |       |
|------------------------|-------|
| Width (left to right)  | 605mm |
| Length (front to back) | 745mm |
| Dome Height            | 305mm |
| Inner Arch Width       | 410mm |
| Inner Arch Height      | 225mm |
| Floor Brick Thickness  | 38mm  |

### INTERNAL COOKING AREA

|                        |       |
|------------------------|-------|
| Width (left to right)  | 605mm |
| Length (front to back) | 570mm |

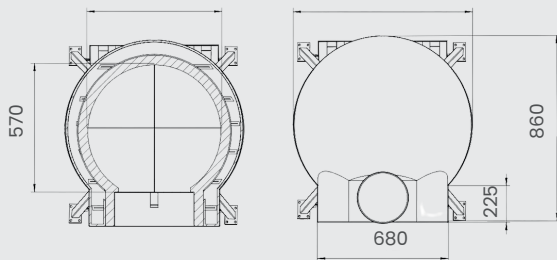

## FLUE DIMENSIONS

|                   |       |
|-------------------|-------|
| Flue Height       | 500mm |
| Flue Diameter     | 150mm |
| Flue Cap Diameter | 275mm |

## BENCHTOP LAYOUT

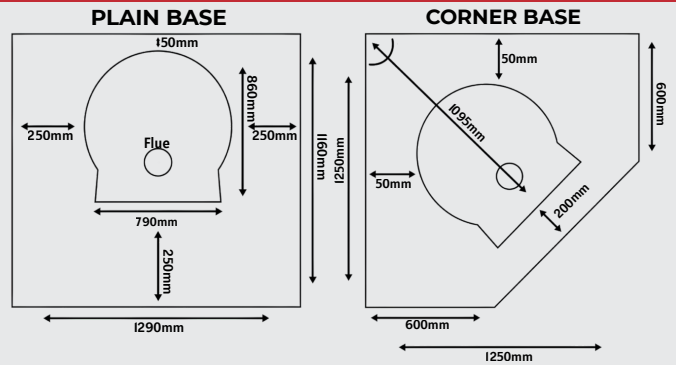

|                               |            |            |
|-------------------------------|------------|------------|
| Suggested Base Height         | 900-1000mm | 900-1000mm |
| Suggested Slab Thickness      |            | 75mm       |
| Suggested Distance from Walls |            | 50mm       |
| Suggested Front Prep Area     |            | 200-250mm  |

## BOX DIMENSIONS

|                              |        |
|------------------------------|--------|
| Width (left to right)        | 1085mm |
| Length (front to back)       | 1015mm |
| Height                       | 705mm  |
| Weight (includes pizza oven) | 265kg  |

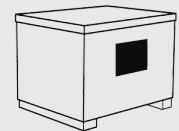

## OPTIONAL EXTRAS

### TAPERED STAND & WHEELS

|                           |        |
|---------------------------|--------|
| Width (left to right)     | 870mm  |
| Length (front to back)    | 1000mm |
| Height (excluding wheels) | 880mm  |
| Stand Weight              | 35kg   |
| Large wheel Height        | 125mm  |



### SQUARE STAND & WHEELS

|                           |        |
|---------------------------|--------|
| Width (left to right)     | 820mm  |
| Length (front to back)    | 620mm  |
| Height (excluding wheels) | 1000mm |
| Stand Weight              | 35kg   |
| Large wheel Height        | 65mm   |



### BENCHTOP LEGS

|                   |       |
|-------------------|-------|
| Adjustable Height | 65mmH |
|-------------------|-------|

### GRANITE BENCH (Square or Curved Front)

|                        |       |
|------------------------|-------|
| Width (left to right)  | 720mm |
| Length (front to back) | 300mm |
| Thickness              | 50mm  |
| Weight                 | 12kg  |



### PIZZA OVEN COVER

|        |     |
|--------|-----|
| Weight | 2kg |
|--------|-----|



© January 2026 All rights reserved.